

1½" & 2" Polypropylene Self-Priming Centrifugal Pumps

MOTOR FEATURES

- Cast iron cylinder sleeve.
- Heavy duty flywheel.
- Overhead valve.
- High oil fill
- Oil Guard® low oil sensor.
- Breather through air cleaner.

PUMP FEATURES

- Precision molded construction.
- Lightweight.
- Corrosion resistant.
- Superior design.
- Low maintenance.
- EPDM Standard, FKM (viton type) available.

CAUTION-WARNING: Please do not run pump dry, restrict or reduce port sizes, or dead head pump. This could cause component failure to pump.

DO NOT USE WITH FLAMMABLE LIQUIDS.

NOTE: Engine warranty service available at authorized Briggs & Stratton and Honda dealers.

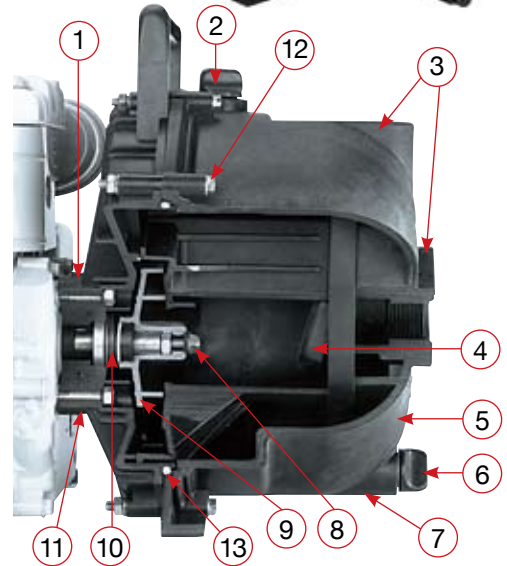

1. Maximum engine protection - pump end is separated from engine
2. Large prime plug thumb screw
3. 1½" & 2" ports
4. Check valve
5. "V" shaped body for quicker priming
6. Large drain plug thumb screw
7. High strength glass-filled polypropylene construction
8. Impeller bolt easily removable
9. High performance precision molded impellers
10. Mechanical shaft seal (available in 3 materials)
11. Large weep holes
12. All stainless steel hardware
13. Heavy duty body O-ring



**200P6PRO
190 GPM**

1½" POLY PUMP W/GAS ENGINE				
PART NO	DESCRIPTION	HP	QTY	PRICE
150P-3	1½" Poly Pump w/3.5 HP Briggs & Stratton® Engine	3.5	1	\$910.11

2" POLY PUMPS W/GAS ENGINES				
PART NO	DESCRIPTION	HP	QTY	PRICE
200P-3	2" Poly Pump w/3.5 HP Briggs & Stratton® Engine	3.5	1	\$910.11
200PH-5	2" Poly Pump w/5.5 HP Honda® Engine	5.5	1	\$1,846.02
200PH-5E	2" Poly Pump w/5.5 HP Honda® Engine w/Electric Start	5.5	1	\$2,637.18
200PH6	2" Poly Pump w/6.5 HP Honda® Engine	6.5	1	\$2,165.82
200P6PRO	2" Poly Pump w/6.5 HP Briggs & Stratton® Engine Pro Series	6.5	1	\$1,058.77

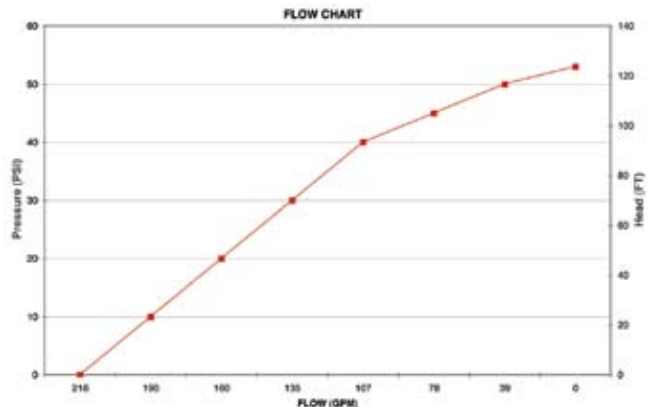

3" Polypropylene Self-Priming Centrifugal Pumps

PUMP FEATURES

- High strength polypropylene.
- Corrosion resistant.
- Lightweight – portable.
- High performance impellers.

APPLICATIONS

- Agricultural pump.
- Contractor pump.
- Emergency use: fires & floods.



300PH-6
6.5 HP HONDA PUMP

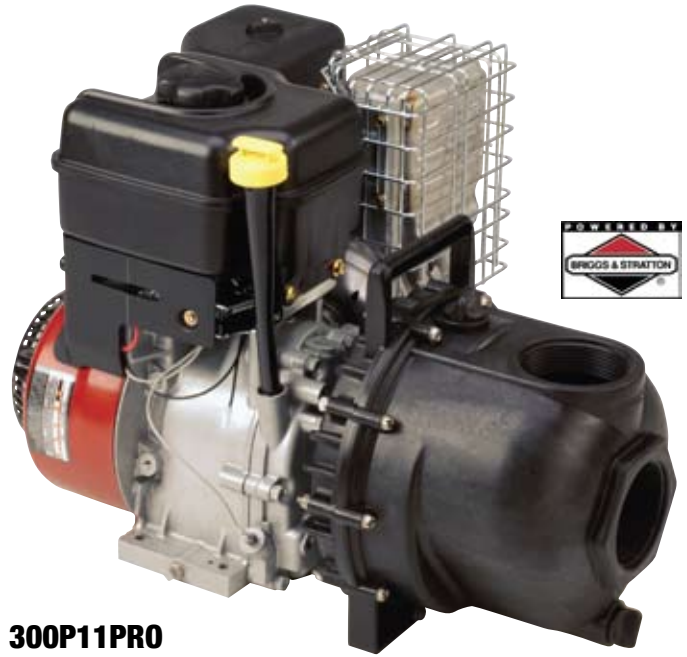

300P11PRO
11HP BRIGGS & STRATTON INTEK PRO PUMP

3" POLY PUMPS W/GAS ENGINES

PART NO	DESCRIPTION	HP	QTY	PRICE
300PH-6	3" Poly Pump w/6.5 HP Honda® Engine	6.5	1	\$2,342.54
300P11PRO	3" Poly Pump w/11 HP Briggs & Stratton® Engine Pro Series	11	1	\$2,235.75

3" POLY BEARING PEDESTAL

PART NO	DESCRIPTION	HP	QTY	PRICE
300PB	3" Poly Bearing Pedestal w/ 3/4" Shaft & 4 Vane Impeller	N/A	1	\$1,016.69

3" POLY PUMP ONLY

PART NO	DESCRIPTION	HP	QTY	PRICE
300PO	3" Poly Pump Only w/ 3/4" Shaft & 4 Vane Impeller Unassembled	N/A	1	\$581.97



PEDESTAL PUMP 300PB & PUMP ONLY 300PO

CAUTION-WARNING: Please do not run pump dry, restrict or reduce port sizes, or dead head pump. This could cause component failure to pump.

DO NOT USE WITH FLAMMABLE LIQUIDS.

NOTE: Engine warranty service available at authorized Briggs & Stratton and Honda dealers.

